

»» Features

- Miniature PCB relays 15A/14VDC
- Available for open frame type or flux free or sealed type.
- Single and twin relays are both available.
- Contact configurations of SPNC, SPNO, SPDT, SPDM-DB are available.
- General application for car alarm control, power window control, wiper control, door lock control, etc.
- Comply with RoHS-Directive 2002/95/EC, and ELV-Directive 2000/53/EC.

»» Type List

Terminal style	Contact form	Internal	Designation			
			Open type	Flux tight	Sealed type	Sealed type washable
PCB terminal	SPNO	Single	861-1A	861-1A-C	861-1A-V	861-1A-S
	SPDM		861-2A	861-2A-C	861-2A-V	861-2A-S
	SPDT		861-1C	861-1C-C	861-1C-V	861-1C-S
	SPDM-DB		861-2C	861-2C-C	861-2C-V	861-2C-S
	SPNO	Twin	-----	861T-1A-C	861T-1A-V	861T-1A-S
	SPDM		-----	861T-2A-C	861T-2A-V	861T-2A-S
	SPDT		-----	861T-1C-C	861T-1C-V	861T-1C-S
	SPDM-DB		-----	861T-2C-C	861T-2C-V	861T-2C-S

»» Ordering Information

861 □ - 1A - □
 1 2 3 4

- | | |
|---|--|
| <p>1. 861 -- Basic series designation</p> <p>2. Blank -- Single relay
T -- Twin relay</p> <p>3. 1A -- Single pole normally open
1B -- Single pole normally close
1C -- Single pole double throw</p> | <p>2A -- Single pole double make
2B -- Single pole double break
2C -- Single pole double make-double break</p> <p>4. Blank -- Open type
C -- Flux tight
V -- Sealed type
S -- Sealed type washable</p> |
|---|--|

»» Contact Rating

Resistive load	SPNO	SPNC	SPDT
	15A/14VDC	10A/14VDC	NC:10A/14VDC , NO:15A/14VDC
	SPDM	SPDB	SPDM-DB
	10AX2/14VDC	7AX2/14VDC	DM:10AX2/14VDC , DB:7AX2/14VDC

»» Coil Rating(DC)

Rated voltage (V)	Rated current $\pm 10\%$ at 23°C (mA)	Coil resistance $\pm 10\%$ at 23°C (Ω)	Max. continuous voltage at 85°C ⁽¹⁾	Pick up voltage(Max) at 23°C	Drop out voltage(Min) at 23°C	Power consumption at rated voltage
6	187.5	32	125 % of rated voltage	60 % of rated voltage 67% (for 2C contact configuration only)	10 % of rated voltage	approx. 1.1W
9	123.2	73				
12	92.3	130				
24	46.1	520				

Note : (1) Continuous contact current at 10A.

»» Specification

Contact material	AgSnO alloy	
Contact voltage drop ⁽¹⁾	Typ. 50mV at 10A	
Insulation resistance ⁽¹⁾	50M Ω Min. (DC 500V)	
Operate time ⁽¹⁾	4ms Max.	
Release time ⁽¹⁾	2ms Max.	
Dielectric strength ⁽¹⁾	Between open contact	: AC 500V , 50/60Hz 1 min.
	Between contact and coil	: AC 500V , 50/60Hz 1 min.
Vibration resistance	Operating extremes	10~500Hz , 4.4G
	Damage limits	10~500Hz , 4.4G
Shock resistance	10G , 11ms , half sine wave pulse	
Life expectancy	Mechanical	10,000,000 operations (frequency 18,000 operations/hr)
	Electrical	100,000 operations (frequency 1,800 operations/hr)
Operating ambient temperature	-40~+85°C (no freezing)	
Weight	Approx. 17.5g	

Note : (1) initial value

»» Outline Dimensions

◆861

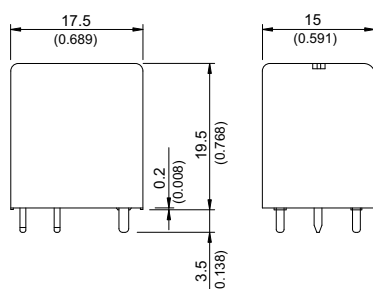

◆861 OPEN TYPE

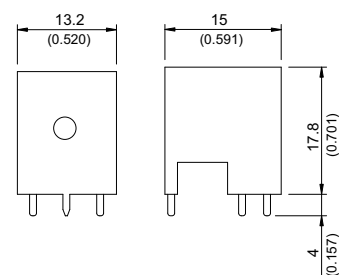

◆ 861T

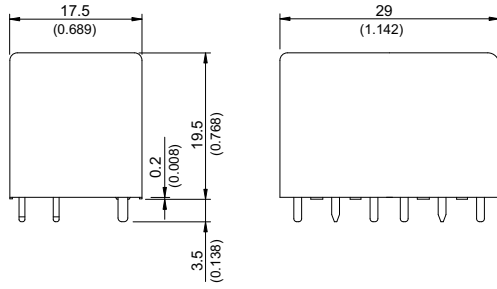

»» Wiring Diagram

BOTTOM VIEW

◆ 861

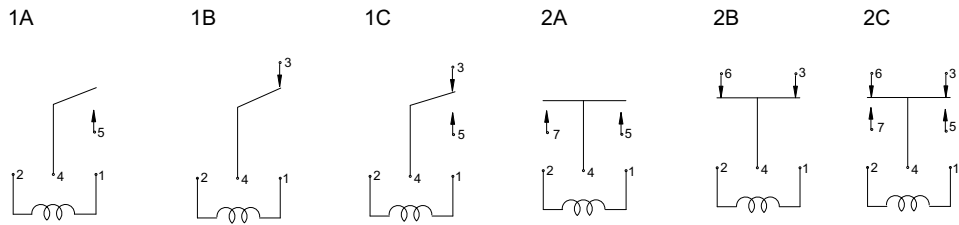

◆ 861T

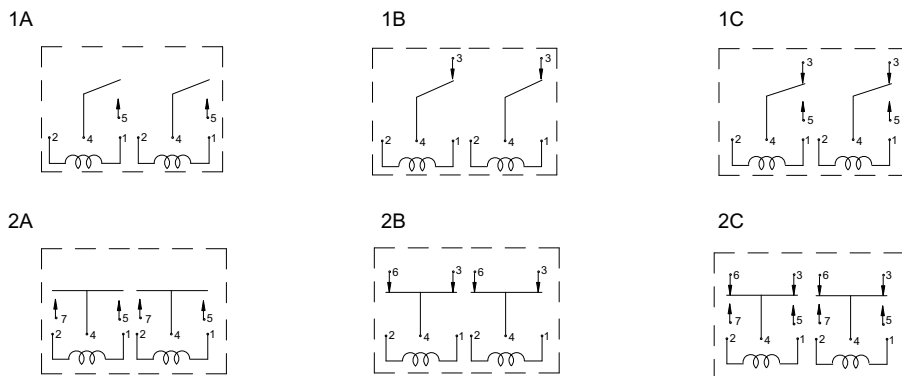

»» PC Board Layout

BOTTOM VIEW

◆ 861

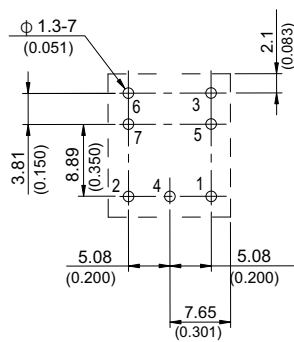

◆ 861 OPEN TYPE

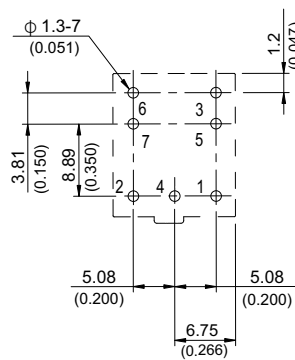

◆ 861T

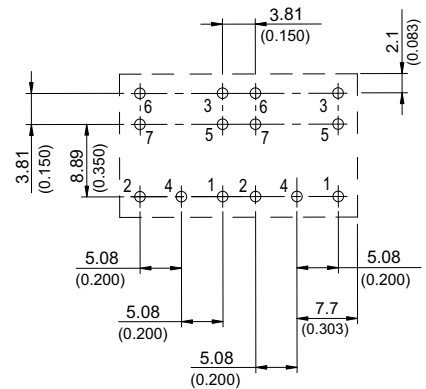

»» Engineering Data

